

460 Series



- The 460 Series is a Block and Tackle balance for **overhead mount** applications.
- Balances are ordered based on stamp.
- We recommend sending in a sample.
- For additional information and sizes, call your WRS sales rep **800.842.0974**
- Weight capacities are listed per pair of balances in lbs.

Single Spring

Double Spring

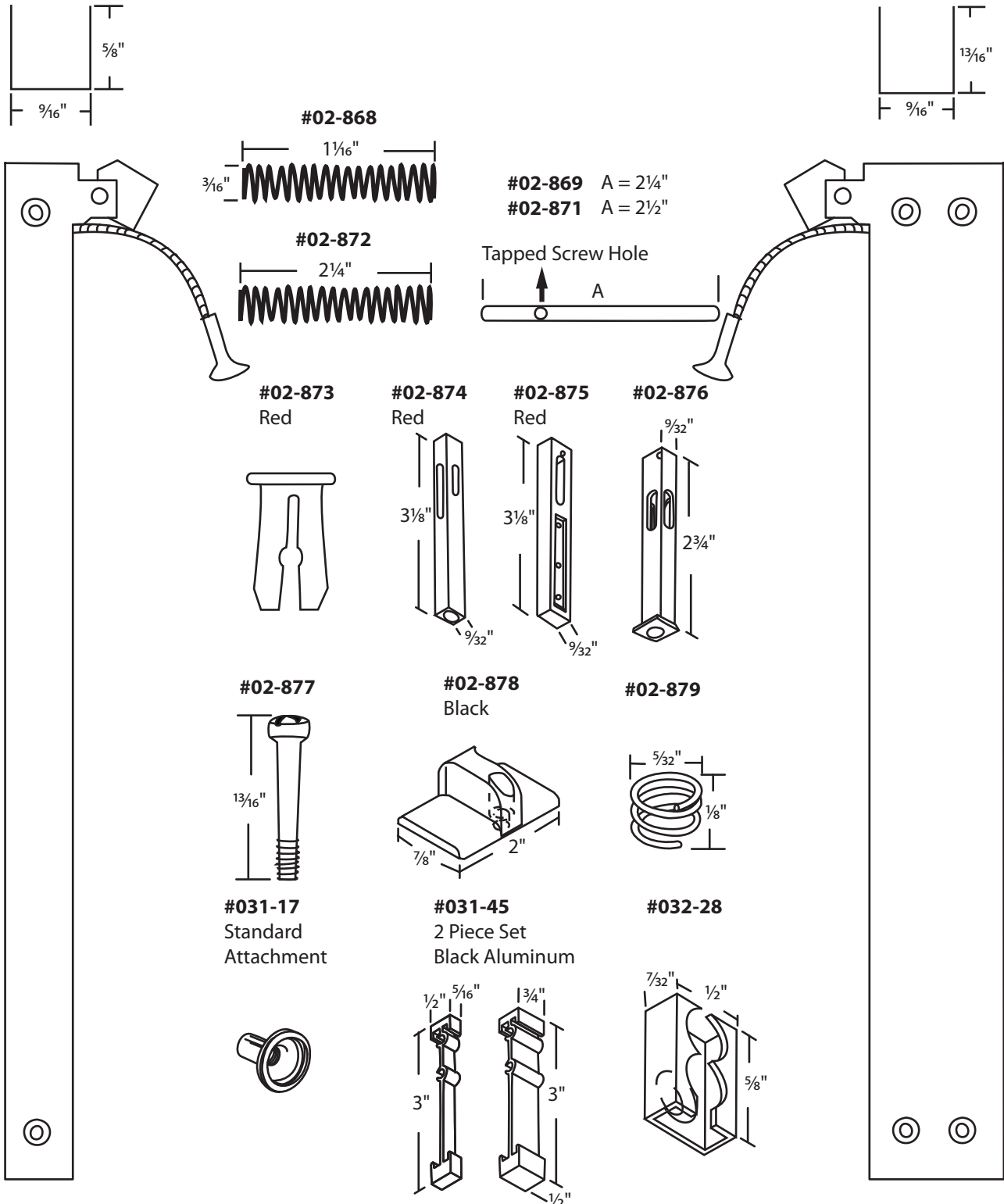

430 Series

The 430 Series is a Block and Tackle balance for **overhead mount** applications.

How to Order:

- Match number stamped on balance
- Match channel length and sash weight.
- Standard clip will be attached unless specified.
- Measure cord Length.
- If the cord is longer than *standard (in chart below), add a plus and the length to the end of the part number. For example, #05-430-11+8, for 8" longer
- Weight capacities are listed per pair of balances in lbs.

Balance Stamp	Channel Length	Cord Length	WRS Part #	Weight Range
111	12¾"	20"	05-430-111	4-7
112	12¾"	20"	05-430-112	7-11
121	15¼"	25"	05-430-121	4-8
122	15¼"	25"	05-430-122	8-12
151	19¼"	33"	05-430-151	5-9
152	19¼"	33"	05-430-152	9-13
153	19¼"	33"	05-430-153	13-16
162	23¼"	36"	05-430-162	9-14
163	23¼"	36"	05-430-163	14-20
183	27¼"	40"	05-430-183	17-22

*Standard cord length is determined by measuring the cord when it is fully extended from the balance.

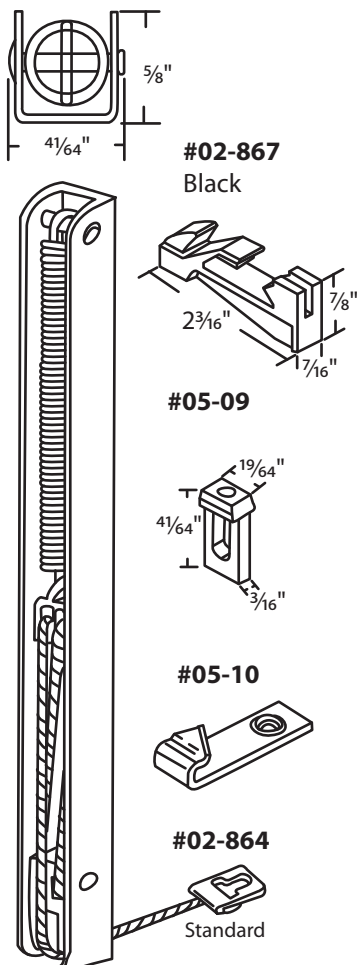

475 Series

The 475 Series is a Block and Tackle balance for **overhead mount** applications.

- Balance is ordered based on stamp.
- For additional information and sizes, call your WRS sales rep **800.842.0974**

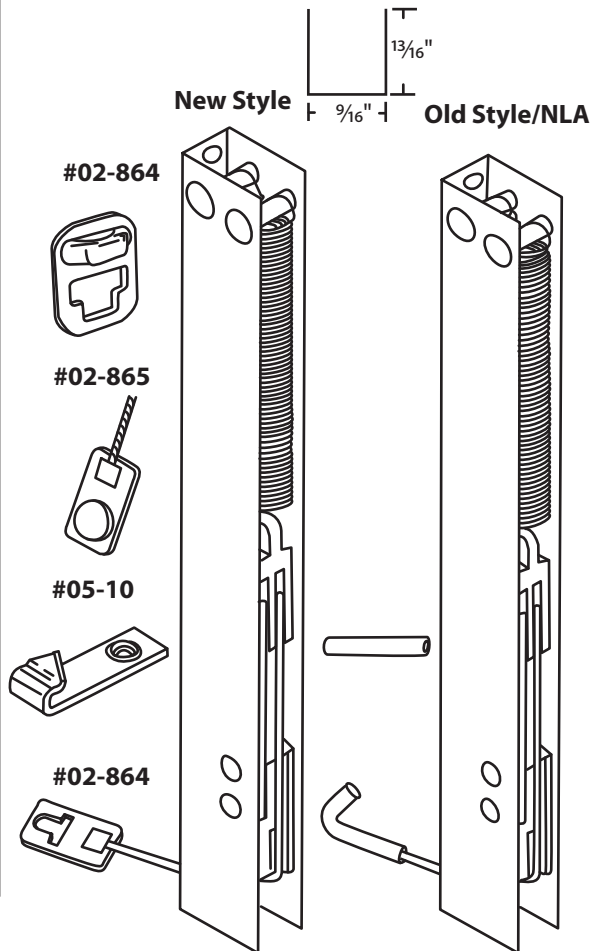

Any questions, call your Account Specialist @ **800.842.0974**